

① [QR code] How to register Grand Seiko electronic warranty by smartphone

What to prepare

- Warranty card
- Watch
- Smartphone



① Attaching the QR code sticker

- 1. Peel the QR code sticker off of the QR code sticker tag that came with the purchased watch, and then attach the sticker to the back side of the warranty card.

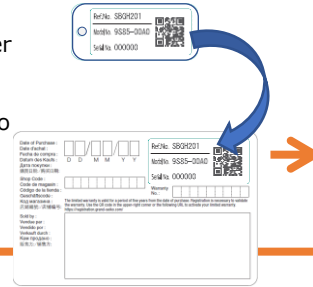

② Entering the date of purchase and shop code and placing shop stamp

- 1. Enter the date of purchase and the shop code.
- 2. Place the shop stamp on the warranty card.



③ Entry page

- Access from the QR code
- 1. Select a language.
- 2. Select your country or region of residence.

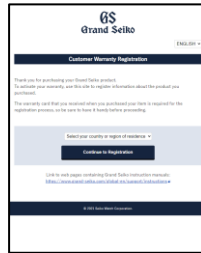

④ Entering the shop code and date of purchase

- 1. Enter the shop code written on the warranty card.
- 2. Enter the date of purchase. Note: This is the date written on the warranty card.

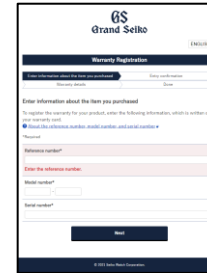

⑤ Checking the entered information

- 1. Make sure that there are no mistakes in the entered information.

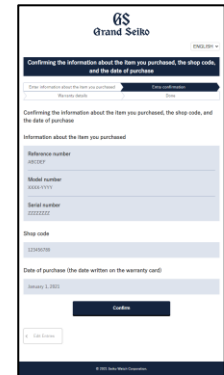

⑥ Checking the warranty details

- 1. Check the details of the registered warranty and the points to note.
- 2. Enter the warranty number on the back of the warranty card.

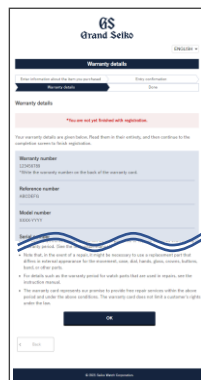

⑦ Finishing registration

- 1. A PDF file containing the warranty details will become available for downloading.



②[QR code] How to check the details of your Grand Seiko electronic warranty by smartphone

■ What to prepare

○ Warranty card

○ Watch

○ Smartphone



① Entering information about the item you purchased

- 1. Access from the QR code
- 2. Touch on the [Check Warranty Details] button.



② Displaying the warranty details

- 1. The warranty details for the registered watch are displayed.
- 2. A PDF file containing the warranty details will become available for downloading.

③ [URL] How to register Grand Seiko electronic warranty by PC

■ What to prepare

- Warranty card
- Watch
- Internet-connected PC



① Attaching the QR code sticker

- 1. Peel the QR code sticker off of the QR code sticker tag that came with the purchased watch, and then attach the sticker to the back side of the warranty card.

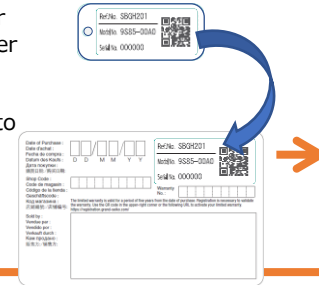

② Entering the date of purchase and shop code and placing shop stamp

- 1. Enter the date of purchase and the shop code.
- 2. Place the shop stamp on the warranty card.



③ Entry page

- Access from a URL on a PC
 - Select a language.
 - Select your country or region of residence.

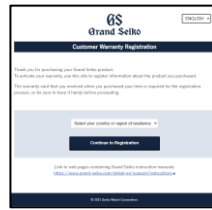

④ Entering information about the purchased item

- 1. Enter information about the purchased item by referring to the warranty card or the case back of the watch.

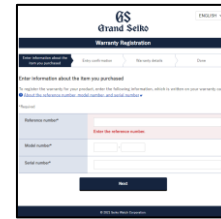
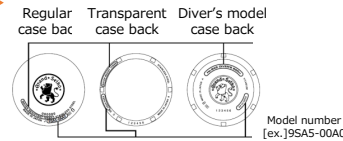

⑤ Entering the shop code and date of purchase

- 1. Enter the shop code written on the warranty card.
- 2. Enter the date of purchase. Note: This is the date written on the warranty card.



⑥ Checking the entered information

- 1. Make sure that there are no mistakes in the entered information.

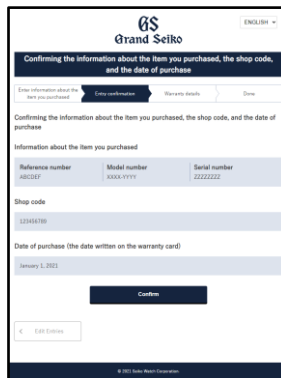

⑧ Checking the warranty details

- 1. Check the details of the registered warranty and the points to note.
- 2. Enter the warranty number on the back of the warranty card.



⑨ Finishing registration

- 1. A PDF file containing the warranty details will become available for downloading.

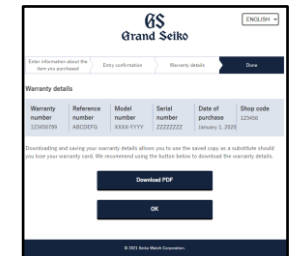

④[URL] How to check the details of your Grand Seiko electronic warranty by PC

■ What to prepare

○ Warranty card

○ Watch

○Internet-connected PC



① Entering information about the item you purchased

- 1. Access from search URL
- 2. Enter information about the item you purchased by referring to the warranty card or the case back of the watch.

Regular case back See-through case back Diver's model case back

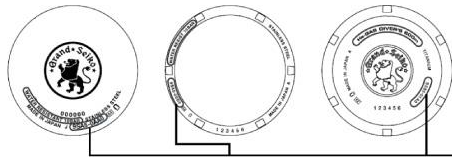

Model number
[ex.]9SA5-00A0

- 3. Click on the [Check Warranty Details] button.



② Displaying the warranty details

- 1. The warranty details for the registered watch are displayed.
- 2. A PDF file containing the warranty details will become available for downloading.